

This drawing is to be read in conjunction with the bill of materials / specification and any related drawings. Contractor must ensure that all items detailed on this drawing must be included when tendering even if not covered by the specification. Any discrepancies must be brought to the attention of the Designer, immediately in writing, prior to works commencing on site.

Any structural works must be carried out in accordance with the appointed structural engineers details and calculations and all works must be inspected at the relevant stages by the structural engineer and building inspector. Any alterations must be approved by the engineer and building inspector. Any costs incurred due to either claims for damages, loss of trade, etc. by failing to do so will be the sole liability of the contractor.

All works must be carried out in accordance with current local authority, British and European standards. If in doubt, it is the responsibility of the contractor to contact all relevant parties.

Under the guidance of CDM 2015, the designer will not commence any work in relation to a project unless completely satisfied that the client is aware of their duties duty owed and obligated to them under these regulations.

This drawing precludes octopus id, from the role of principal designer unless otherwise contractually engaged.

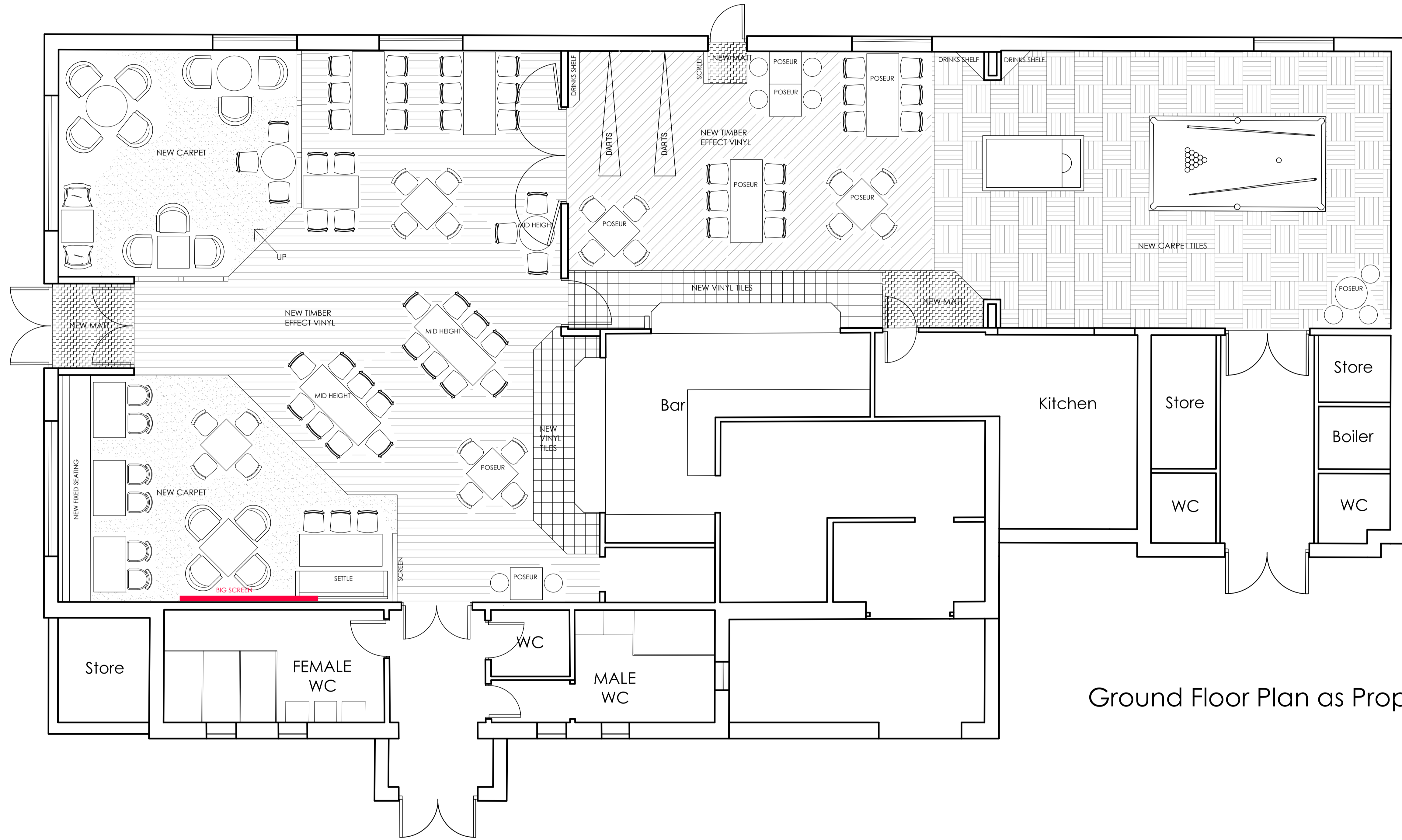

Ground Floor Plan as Proposed

A 3.12.20 DI Alterations to layout following clients comments
 rev. date, initials, comment.

octopusid
 one navigation court, calder park, wakefield, west yorkshire, wf2 7tz
 tel: 01924 249333 www.octopusid.co.uk

for PRIVATE CLIENT
 project HARWELLIAN, DIDCOT

drawing name	PLAN AS PROPOSED	by	DI
date	24.11.20	scale @ A1	1/50
drawing number	02	revision	A

This drawing is the copyright of octopus id. Copyright is reserved by them and the drawing is issued on condition that it is not copied, reproduced, retained or disclosed to any unauthorised persons, either wholly or in part without the written consent of octopus id. This drawing has been prepared for presentation purposes, consultants wishing to use the drawing for guidance must check all dimensions on site prior to finalising their element of work undertaken and any discrepancies must be brought to the attention of the Designer, immediately in writing.

© copyright